

Floor Plan For Glass Building

First Floor

12050mm

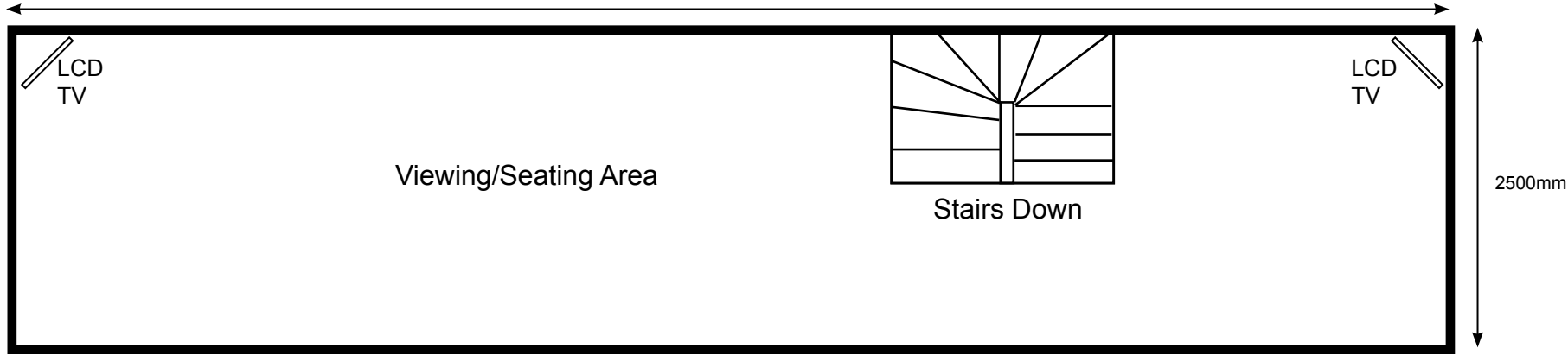

Ground Floor

1800mm

1000mm

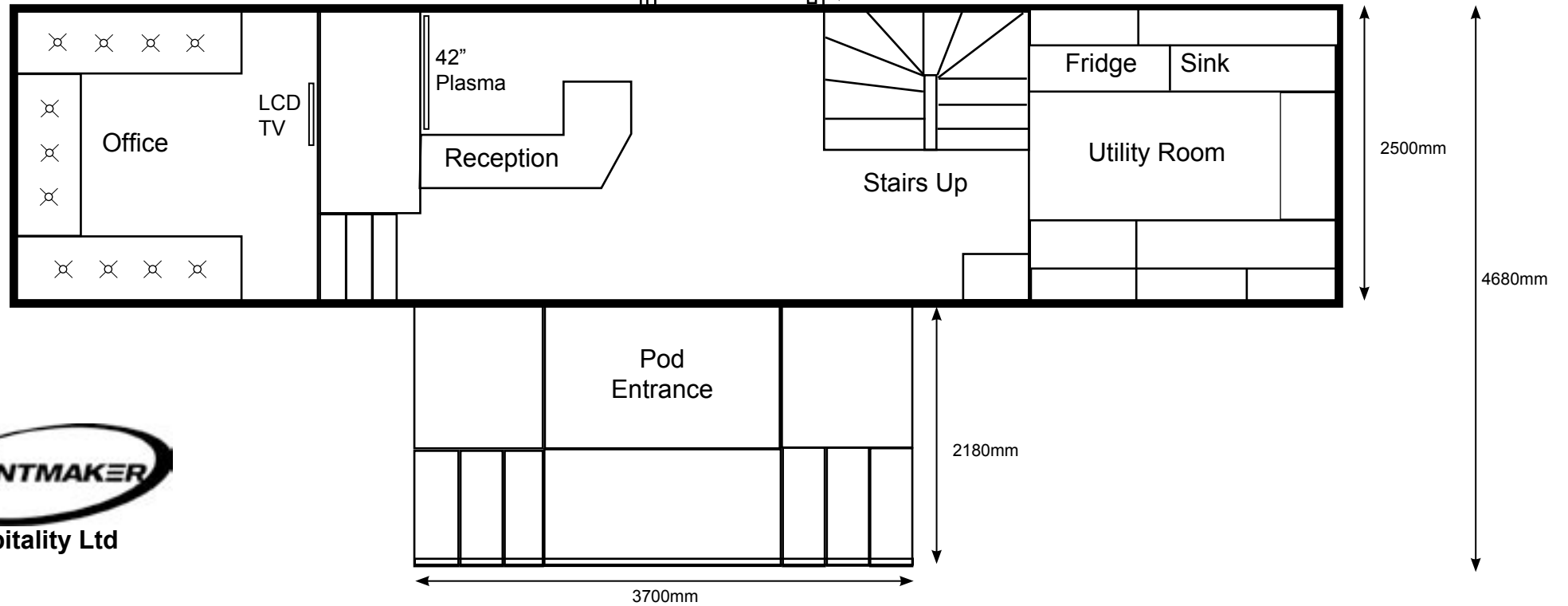

Glass Building Specification

Travelling Dimensions:

2 axle Trailer
12m Long
2.5m Wide
4.0m High

Set Up Dimensions:

12m Long
Overall Width 5.7m wide - Trailer 2.5m wide
Entrance pod and steps 2.2m wide
Rear steps 1.8m wide

6.0m High

Power Supply Required (To set up and run trailer):

32Amp 3 Phase

Ground Floor:

Entrance Pod -	2 x Sets of steps Sliding Glass Entrance Doors
Reception Area -	Reception Desk Plasma Screen Controls for Air Con, Plasma, DVD Sliding Glass Doors to Rear
Office Area -	Leather Seating LCD TV Table
Utility Room	Worktops with Under Counter Fridge Overhead Storage / Sink Power Points



Hospitality Ltd

Monarch House, Coxmoor Road, Sutton in Ashfield, Notts. NG17 5LA
Tel: 0845 1949061 Fax: 0845 1949063 E-mail: info@eventmaker.co.uk

First Floor:

Viewing/Seating Area with Panoramic Views
2 x LCD TV's
Air Conditioning
6 x Power Points

Branding Areas:

Above Entrance Doors -	3715mm wide x 1700mm deep
Either Side of Doors -	922mm wide x 2212mm deep (x2)
Below Entrance Steps -	1860mm wide x 650mm deep
Flags -	1500mm x 1000mm

Awning Options:

12m x 9m awning to rear of unit
15m x 9m awning with entrance area to LH side
1/2 height panels with roll up windows across 12m/15m length

